

# R-105056 Oxygen Carry Kit

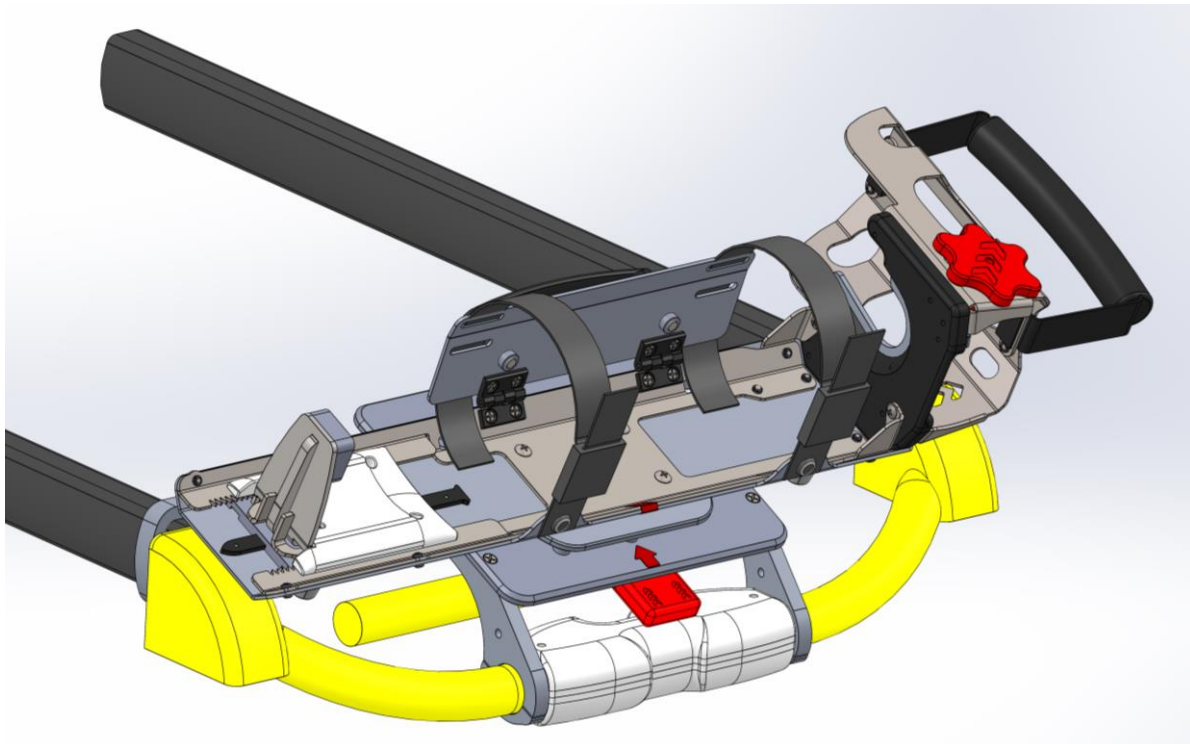

## Operations Manual



# Table of Contents

---

System Components .....	3
Dock.....	3
Carry Unit .....	3
Back Rest Guard .....	4
Device Operation .....	6
Loading Oxygen Cylinder .....	6
Attaching Straps .....	7
Cylinder Valve Tool.....	7
Securing the Cary for Transport.....	9
On Cot Dock.....	9
Secured in Vehicle .....	10



## System Components

---

### Dock

The dock mounts to the head end of the cot and is used to secure a carry unit to the cot. The below image outlines and key parts of the dock.

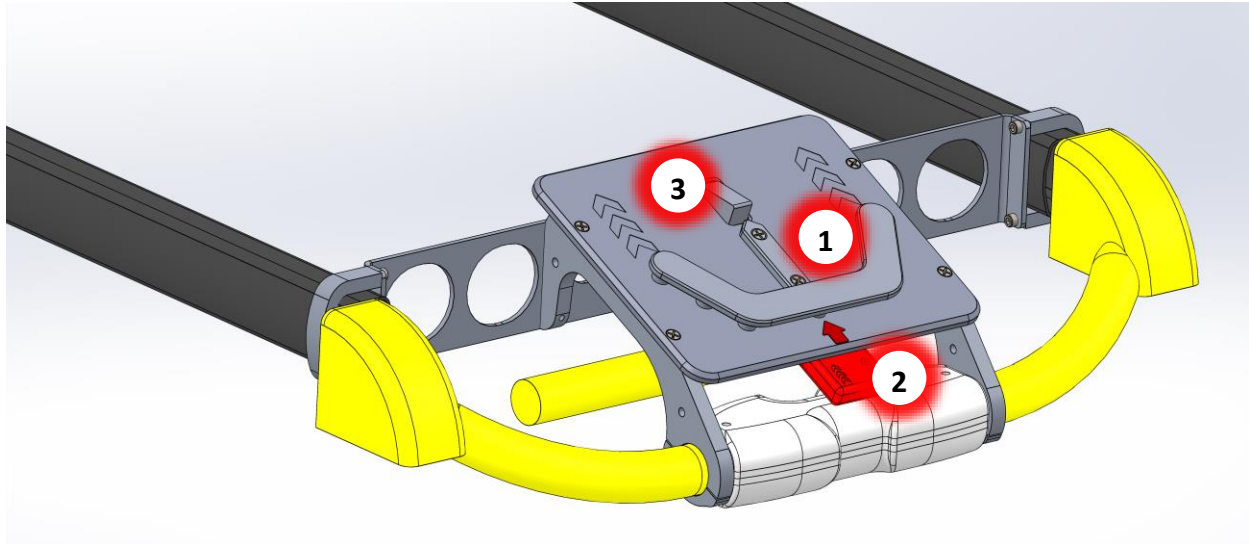

Item	Function
1	Carry guide, this is used to align the carry when docking.
2	Release, pressing this in will release the carry unit from the dock.
3	Latch, this locks the carry into the dock.

### Carry Unit

The carry unit is the main part of the system that secures and protects the oxygen cylinder. The below image outlines the key parts of the carry unit.



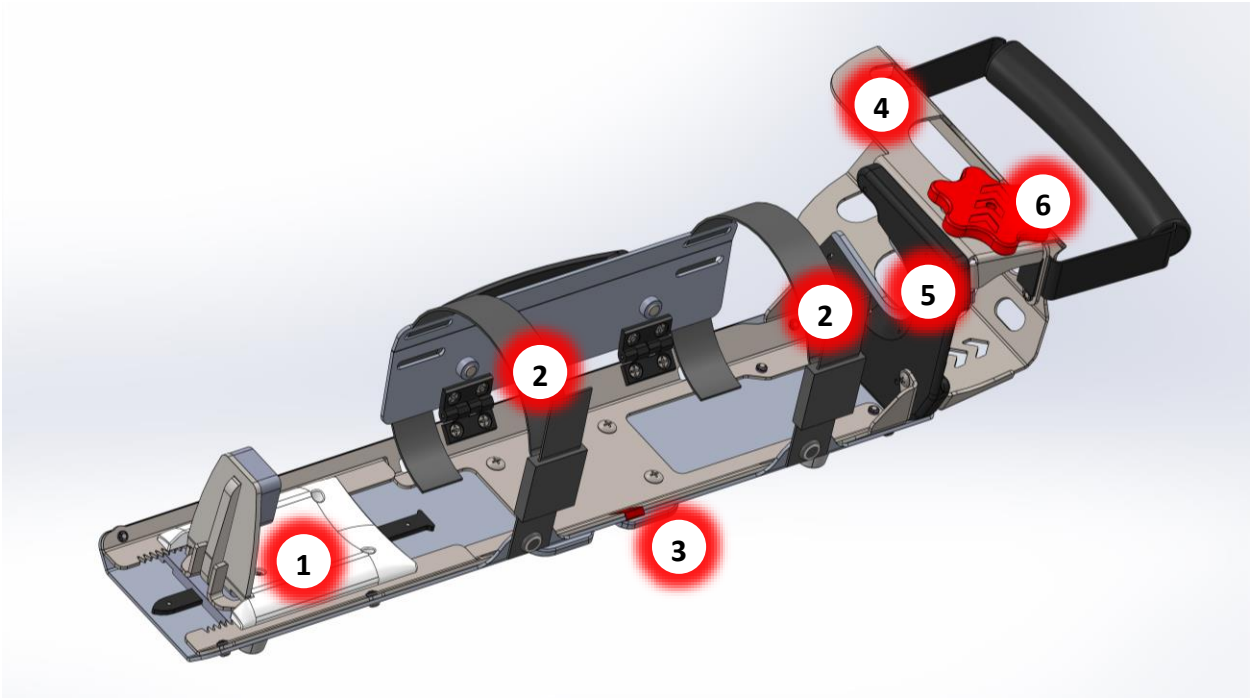

Item	Function
1	End stop, this adjusts to the different size cylinders and holds its neck up to the neck guide.
2	Cylinder straps, the straps are used to secure the cylinder in the carry
3	Docking foot
4	Regulator cover
5	Cylinder neck guide
6	Valve tool in its storage position

### Back Rest Guard

The backrest guard mounts to the back rest and is used to prevent the backrest adjusting lever from contacting the oxygen cylinder. The below image shows the backrest guard installed on the backrest.





# Device Operation

## Loading Oxygen Cylinder

Below are the key points for loading a cylinder into the oxygen carry unit.

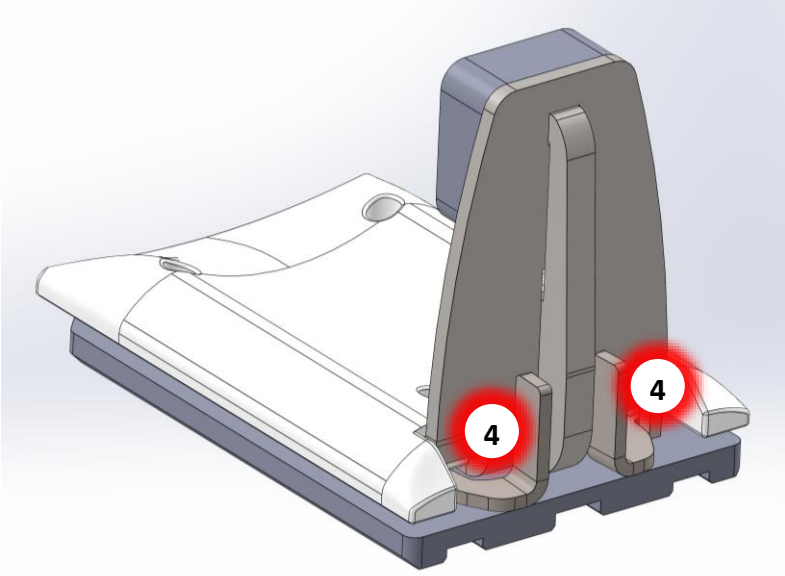
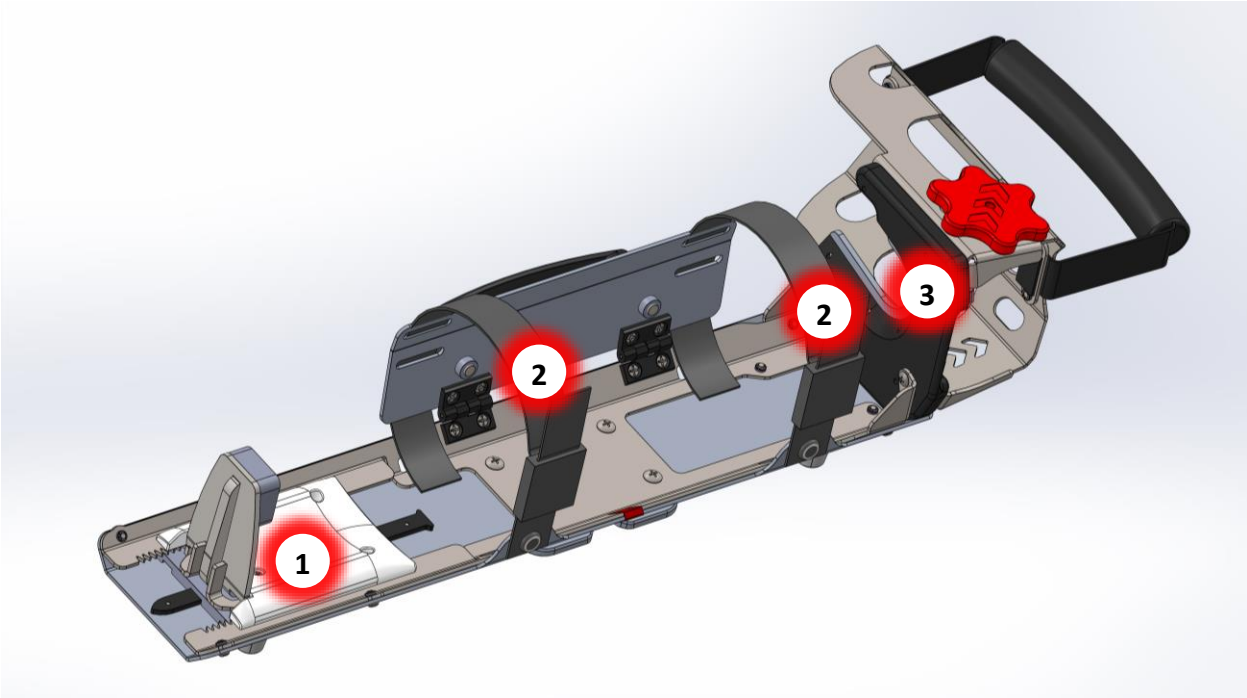

1. Move the end stop (1) to the rear to give room for the new bottle to be inserted. To move the end stop press the two release levers (4) together.
2. Open the cam buckle straps (2).
3. Insert cylinder with regulator attached making sure the neck of the cylinder is tight in the neck guide (3).
4. Reattach the cam buckle straps (2) and tighten.
5. Tighten the end stop (1) on the cylinder.

## Attaching Straps

The cam buckle straps may need to be removed from the unit for cleaning, after cleaning it is important that they get reattached correctly. The yellow line in the below image shows the correct strap routing. The cam buckle (1) must be positioned as shows and the snap (2) must be attached to the snap stud.

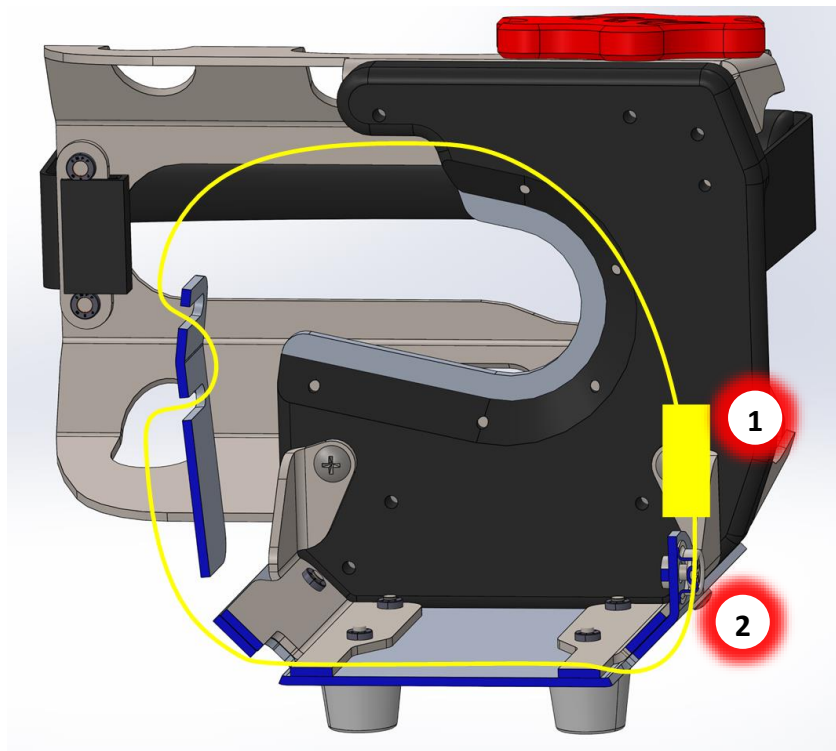

## Cylinder Valve Tool

The cylinder valve tool is used to turn on and off the flow of gas from the cylinder to the regulator. The cylinder valve tool has two magnets embedded in it that holds it in its storage location shown in the below image.



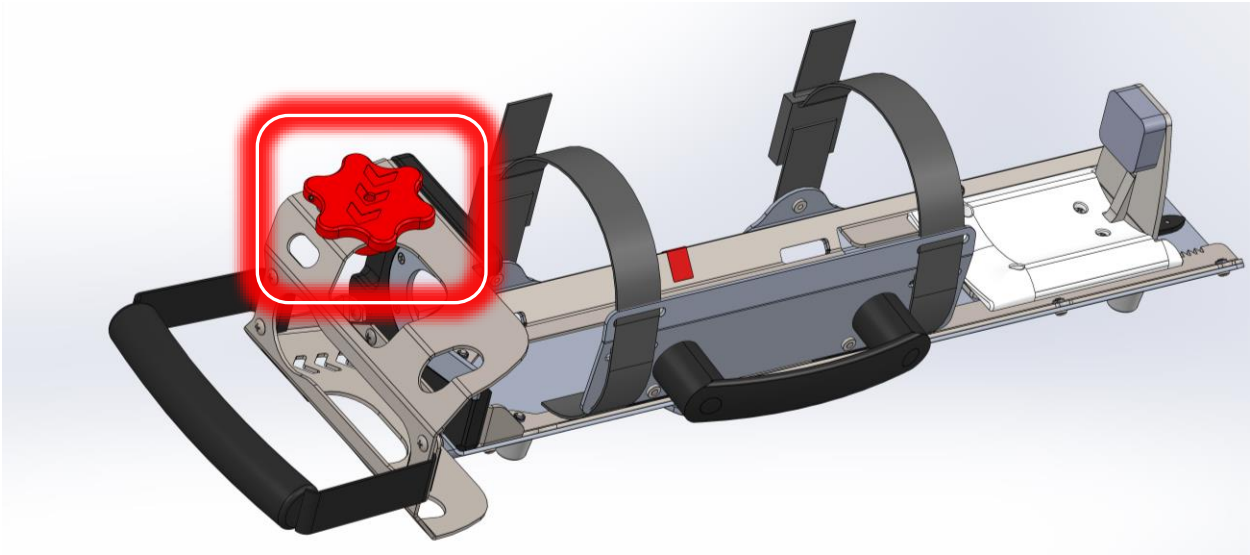



## Securing the Carry for Transport

### On Cot Dock

The oxygen carry unit can be secured to the cot dock for transport as shown in the image below.

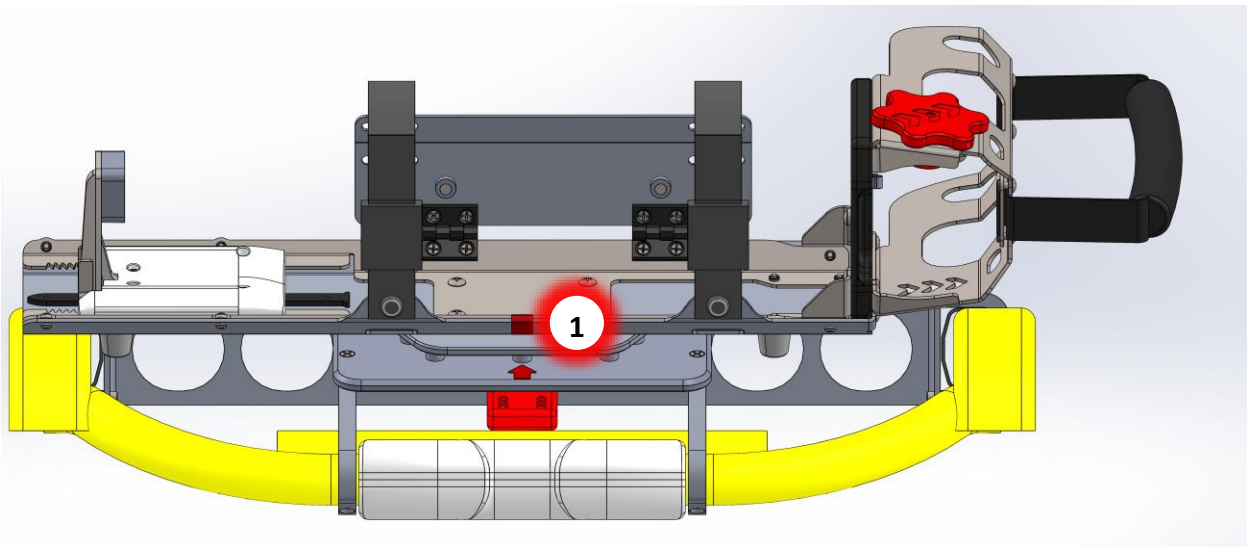

The docking plate is shown in the image below.

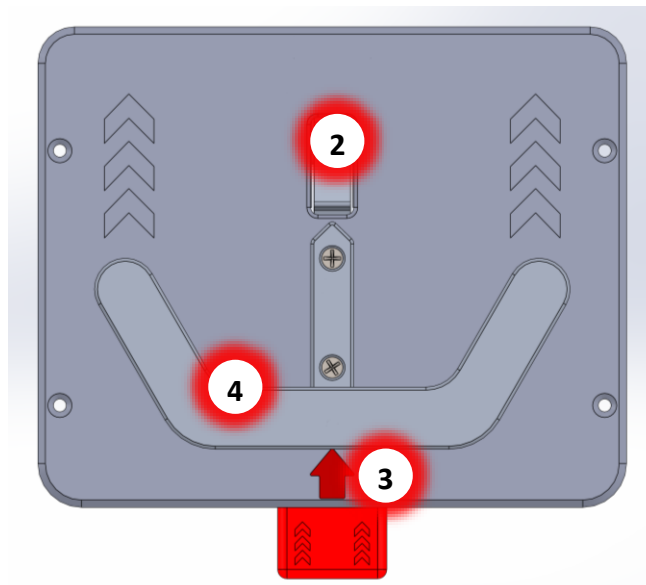

When securing the carry unit in the dock the user should aim for the carry unit's docking foot to contact the docking plate in the latch area (2). Then the positioning of the red bar (1) and the red arrow (3) should be checked, and the carry unit should be adjusted so they are in line with each

other as shown in the docked image above. The carry unit should then be slid down so the docking foot rests in the cradle on the docking plate (4). While sliding the unit down the user needs to listen for the click of the latch returning to the locked position. **LASTLY THE USER SHOULD ATTEMPT TO REMOVE THE CARRY UNIT FROM THE DOCK TO ENSURE IT IS LOCKED IN.**

The oxygen carry unit can only be secured in the dock in the orientation shown, **IT WILL NOT LOCK IN TO THE DOCK WITH THE REGULATOR ON THE PATIENT LEFT SIDE OF THE COT.**

### Secured in Vehicle

The oxygen carry can also be secured in the vehicle loose from the cot dock. Both handles, indicated with (1) and (2) can be used to secure the unit with seat belt.

